

Permit with introductory note

The Environmental Permitting (England & Wales) Regulations 2010

CWM Environmental Limited

Nantycaws HCl Waste Transfer &
Treatment Facility
Llanddarog Road
Nantycaws
Carmarthen
SA32 8BG

Permit number
EPR/EP3698FL

Nantycaws HCI Transfer & Treatment Facility

Permit number EPR/EP3698FL

Introductory note

This introductory note does not form a part of the permit

The main features of the permit are as follows.

This permit is for the recovery and disposal of a non-hazardous and hazardous household, commercial and industrial waste transfer and treatment facility. The HCI waste transfer with treatment station includes enclosed vessel composting and open windrow composting activities where the recovery of non-hazardous biodegradable wastes must be carried out under aerobic conditions. It also permits the recovery of wastes for the production of soil, soil substitutes and aggregates. The total throughput is 100,000 tonnes a year.

Any wastes controlled by the Animal By-products Regulations (ABPR) must be handled and treated in accordance with any requirements imposed by those Regulations.

The waste types permitted for the enclosed vessel composting activity and part of the open windrow composting activity are subject to PAS 100 and the Environment Agency's Quality Protocol Appendix B list in order to meet the End-of-Waste (EoW) criteria for compost.

The status log of the permit sets out the permitting history, including any changes to the permit reference number.

Status log of the permit

Description	Date	Comments
EAWML 34207 determined	02/09/03	Permit issued to CWM Environmental Limited.
Variation determined EPR/EP3698FL/V002 (previously EAWML 34207)	05/10/04	Varied to amend Tables 1.1 and 1.2
Application EPR/EP3698FL/V003 (previously EAWML 34207)	Duly Made 17/08/12	Application to include composting and additional waste codes resulting in the re-classification of the site to a hazardous and non-hazardous HCI WTS with treatment. It also includes an extension to the site boundary.
Variation determined EPR/EP3698FL	08/11/12	Varied and consolidated permit issued in modern condition format.
Application received EPR/EP3698FL/V004 variation and consolidation.	Duly Made 03/06/15	Application to vary the permit to include a newly prescribed activity following the introduction of the Industrial Emission Directive.

Status log of the permit

Description	Date	Comments
Variation determined EPR/EP3698FL/V004	06/07/15	Varied and consolidated permit issued.

End of introductory note

Permit

The Environmental Permitting (England and Wales) Regulations 2010

Permit number
EPR/EP3698FL

This is the consolidated permit referred to in the variation and consolidation notice for application **EPR/EP3698FL/V004** authorising

CWM Environmental Limited (“the operator”),

whose registered office is
MRF Unit
Cillefwr Industrial Estate
Carmarthen
SA31 3RA

company registration number **02640102**

to operate an installation at
Nantycaws HCI Waste Transfer Station
Nantycaws
Carmarthen
SA32 8BG

to the extent authorised by and subject to the conditions of this permit.

Name	Date
	06 July 2015

Eirian Macdonald

Authorised on behalf of Natural Resources Wales

Conditions

1 Management

1.1 General management

- 1.1.1 The operator shall manage and operate the activities:
- (a) in accordance with a written management system that identifies and minimises risks of pollution, including those arising from operations, maintenance, accidents, incidents, non-conformances, closure and those drawn to the attention of the operator as a result of complaints; and
 - (b) using sufficient competent persons and resources.
- 1.1.2 Records demonstrating compliance with condition 1.1.1 shall be maintained.
- 1.1.3 Any person having duties that are or may be affected by the matters set out in this permit shall have convenient access to a copy of it kept at or near the place where those duties are carried out.
- 1.1.4 The operator shall comply with the requirements of an approved competence scheme.

1.2 Energy efficiency

- 1.2.1 The operator shall:
- (a) take appropriate measures to ensure that energy is used efficiently in the activities;
 - (b) review and record at least every four years whether there are suitable opportunities to improve the energy efficiency of the activities; and
 - (c) take any further appropriate measures identified by a review.

1.3 Efficient use of raw materials

- 1.3.1 The operator shall:
- (a) take appropriate measures to ensure that raw materials and water are used efficiently in the activities;
 - (b) maintain records of raw materials and water used in the activities;
 - (c) review and record at least every four years whether there are suitable alternative materials that could reduce environmental impact or opportunities to improve the efficiency of raw material and water use; and
 - (d) take any further appropriate measures identified by a review.

1.4 Avoidance, recovery and disposal of wastes produced by the activities

- 1.4.1 The operator shall take appropriate measures to ensure that:
- (a) the waste hierarchy referred to in Article 4 of the Waste Framework Directive is applied to the generation of waste by the activities; and
 - (b) any waste generated by the activities is treated in accordance with the waste hierarchy referred to in Article 4 of the Waste Framework Directive; and
 - (c) where disposal is necessary, this is undertaken in a manner which minimises its impact on the environment.

- 1.4.2 The operator shall review and record at least every four years whether changes to those measures should be made and take any further appropriate measures identified by a review.

2 Operations

2.1 Permitted activities

- 2.1.1 The operator is only authorised to carry out the activities specified in schedule 1 table S1.1 (the “activities”).
- 2.1.2 Waste authorised by this permit shall be clearly distinguished from any other waste on the site.

2.2 The site

- 2.2.1 The activities shall not extend beyond the site, being the land shown edged in green on the site plan at schedule 7 to this permit.

2.3 Operating techniques

- 2.3.1 (a) The activities shall, subject to the conditions of this permit, be operated using the techniques and in the manner described in the documentation specified in schedule 1, table S1.2, unless otherwise agreed in writing by Natural Resources Wales.
- (b) If notified by Natural Resources Wales that the activities are giving rise to pollution, the operator shall submit to Natural Resources Wales for approval within the period specified, a revision of any plan or other documentation (“plan”) specified in schedule 1, table S1.2 or otherwise required under this permit which identifies and minimises the risks of pollution relevant to that plan, and shall implement the approved revised plan in place of the original from the date of approval, unless otherwise agreed in writing by Natural Resources Wales.
- 2.3.3 Waste shall only be accepted if:
- (a) it is of a type and quantity listed in schedule 2 table(s) S2.1, S2.2, S2.3, S2.4 and S2.5; and
- (b) it conforms to the description in the documentation supplied by the producer and holder.
- 2.3.4 The operator shall ensure that where waste produced by the activities is sent to a relevant waste operation, that operation is provided with the following information, prior to the receipt of the waste:
- (a) the nature of the process producing the waste;
- (b) the composition of the waste;
- (c) the handling requirements of the waste;
- (d) the hazardous property associated with the waste, if applicable; and
- (e) the waste code of the waste.
- 2.3.5 The operator shall ensure that where waste produced by the activities is sent to a landfill site, it meets the waste acceptance criteria for that landfill.

Waste battery and accumulator treatment

- 2.3.6 Treatment of waste batteries and accumulators must meet the minimum requirements set out in Annex III, Part A of Directive 2006/66/EC of the European Parliament and of the Council on batteries and accumulators and waste batteries and accumulators and repealing Directive 91/157/EEC.

Hazardous waste storage and treatment

- 2.3.6 Hazardous waste shall not be mixed, either with a different category of hazardous waste or with other waste, substances or materials, unless it is authorised by schedule 1 table S1.1 and appropriate measures are taken.

2.4 Improvement programme

- 2.4.1 The operator shall complete the improvements specified in schedule 1 table S1.3 by the date specified in that table unless otherwise agreed in writing by Natural Resources Wales.
- 2.4.2 Except in the case of an improvement which consists only of a submission to Natural Resources Wales, the operator shall notify Natural Resources Wales within 14 days of completion of each improvement.

2.5 Pre-operational conditions

- 2.5.1 The activities shall not be brought into operation until the measures specified in schedule 1 table S1.4A have been completed.

3 Emissions and monitoring

3.1 Emissions to water, air or land

- 3.1.1 There shall be no point source emissions to water, air or land except from the sources and emission points listed in schedule 3 tables S3.1, S3.2 and S3.3.
- 3.1.2 The limits given in schedule 3 shall not be exceeded.
- 3.1.3 Total annual emissions from the emission point(s) set out in tables schedule 3 S3.1, S3.2 and S3.3 of a substance listed in schedule 3 table S3.4 shall not exceed the relevant limit in table S3.4.
- 3.1.4 Periodic monitoring shall be carried out at least once every 5 years for groundwater and 10 years for soil, unless such monitoring is based on a systematic appraisal of the risk of contamination.

3.2 Emissions of substances not controlled by emission limits

- 3.2.1 Emissions of substances not controlled by emission limits (excluding odour) shall not cause pollution. The operator shall not be taken to have breached this condition if appropriate measures, including, but not limited to, those specified in any approved emissions management plan, have been taken to prevent or where that is not practicable, to minimise, those emissions.
- 3.2.2 The operator shall:

- (a) if notified by Natural Resources Wales that the activities are giving rise to pollution, submit to Natural Resources Wales for approval within the period specified, an emissions management plan which identifies and minimises the risks of pollution from emissions of substances not controlled by emission limits;
- (b) implement the approved emissions management plan, from the date of approval, unless otherwise agreed in writing by Natural Resources Wales.

3.2.3 All liquids in containers, whose emission to water or land could cause pollution, shall be provided with secondary containment, unless the operator has used other appropriate measures to prevent or where that is not practicable, to minimise, leakage and spillage from the primary container.

3.3 Monitoring

3.3.1 The operator shall, unless otherwise agreed in writing by Natural Resources Wales, undertake the monitoring specified in the following tables in schedule 3 to this permit:

- (a) point source emissions specified in tables S3.1 and S3.2;
- (b) process monitoring specified in table S3.3;
- (c) bioaerosol monitoring specified in table S3.4;
- (d) surface water specified in table S3.5;

3.3.2 The operator shall maintain records of all monitoring required by this permit including records of the taking and analysis of samples, instrument measurements (periodic and continual), calibrations, examinations, tests and surveys and any assessment or evaluation made on the basis of such data.

3.3.3 Monitoring equipment, techniques, personnel and organisations employed for the emissions monitoring programme and the environmental or other monitoring specified in condition 3.3.1 shall have either MCERTS certification or MCERTS accreditation (as appropriate), where available, unless otherwise agreed in writing by Natural Resources Wales.

3.3.4 Permanent means of access shall be provided to enable sampling/monitoring to be carried out in relation to the emission points specified in schedule 3 tables S3.1 and S3.2 unless otherwise agreed in writing by Natural Resources Wales.

3.4 Odour

3.4.1 Emissions from the activities shall be free from odour at levels likely to cause pollution outside the site, as perceived by an authorised officer of Natural Resources Wales, unless the operator has used appropriate measures, including, but not limited to, those specified in any approved odour management plan, to prevent or where that is not practicable to minimise the odour.

3.4.2 The operator shall:

- (a) if notified by Natural Resources Wales that the activities are giving rise to pollution outside the site due to odour, submit to Natural Resources Wales for approval within the period specified, an odour management plan which identifies and minimises the risks of pollution from odour;
- (b) implement the approved odour management plan, from the date of approval, unless otherwise agreed in writing by Natural Resources Wales.

3.5 Noise and vibration

- 3.5.1 Emissions from the activities shall be free from noise and vibration at levels likely to cause pollution outside the site, as perceived by an authorised officer of Natural Resources Wales, unless the operator has used appropriate measures, including, but not limited to, those specified in any approved noise and vibration management plan to prevent or where that is not practicable to minimise the noise and vibration.
- 3.5.2 The operator shall:
- (a) if notified by Natural Resources Wales that the activities are giving rise to pollution outside the site due to noise and vibration, submit to Natural Resources Wales for approval within the period specified, a noise and vibration management plan which identifies and minimises the risks of pollution from noise and vibration;
 - (b) implement the approved noise and vibration management plan, from the date of approval, unless otherwise agreed in writing by Natural Resources Wales.

3.6 Pests

- 3.6.1 The activities shall not give rise to the presence of pests which are likely to cause pollution, hazard or annoyance outside the boundary of the site. The operator shall not be taken to have breached this condition if appropriate measures, including, but not limited to, those specified in any approved pests management plan, have been taken to prevent or where that is not practicable, to minimise the presence of pests on the site.
- 3.6.2 The operator shall:
- (a) if notified by Natural Resources Wales, submit to Natural Resources Wales for approval within the period specified, a pests management plan which identifies and minimises risks of pollution, hazard or annoyance from pests;
 - (b) implement the pests management plan, from the date of approval, unless otherwise agreed in writing by Natural resources Wales

4 Information

4.1 Records

- 4.1.1 All records required to be made by this permit shall:
- (a) be legible;
 - (b) be made as soon as reasonably practicable;
 - (c) if amended, be amended in such a way that the original and any subsequent amendments remain legible, or are capable of retrieval; and
 - (d) be retained, unless otherwise agreed in writing by Natural Resources Wales, for at least 6 years from the date when the records were made, or in the case of the following records until permit surrender:
 - (i) off-site environmental effects; and
 - (ii) matters which affect the condition of the land and groundwater.
- 4.1.2 The operator shall keep on site all records, plans and the management system required to be maintained by this permit, unless otherwise agreed in writing by Natural Resources Wales.

4.2 Reporting

- 4.2.1 The operator shall send all reports and notifications required by the permit to Natural Resources Wales using the contact details supplied in writing by Natural Resources Wales.
- 4.2.2 A report or reports on the performance of the activities over the previous year shall be submitted to Natural Resources Wales by 31 January (or other date agreed in writing by Natural Resources Wales) each year. The report(s) shall include as a minimum:(a) a review of the results of the monitoring and assessment carried out in accordance with the permit including an interpretive review of that data;
- (b) the annual production /treatment data set out in schedule 4 table S4.2; and
 - (c) the performance parameters set out in schedule 4 table S4.3 using the forms specified in table S4.4 of that schedule.
- 4.2.3 Within 28 days of the end of the reporting period the operator shall, unless otherwise agreed in writing by Natural Resources Wales, submit reports of the monitoring and assessment carried out in accordance with the conditions of this permit, as follows:
- (a) in respect of the parameters and emission points specified in schedule 4 table S4.1;
 - (b) for the reporting periods specified in schedule 4 table S4.1 and using the forms specified in schedule 4 table S4.4 ; and
 - (c) giving the information from such results and assessments as may be required by the forms specified in those tables.
- 4.2.4 The operator shall, unless notice under this condition has been served within the preceding four years, submit to Natural Resources Wales, within six months of receipt of a written notice, a report assessing whether there are other appropriate measures that could be taken to prevent, or where that is not practicable, to minimise pollution.
- 4.2.5 Within 1 month of the end of each quarter, the operator shall submit to Natural Resources Wales using the form made available for the purpose, the information specified on the form relating to the site and the waste accepted and removed from it during the previous quarter.
- 4.2.6 The operator shall submit an annual solvent management plan in order to demonstrate compliance with the requirements of the Industrial Emissions Directive, by 31 January each year in respect of the previous year.

4.3 Notifications

- 4.3.1 (a) In the event that the operation of the activities gives rise to an incident or accident which significantly affects or may significantly affect the environment, the operator must immediately—
- (i) inform Natural Resources Wales,
 - (ii) take the measures necessary to limit the environmental consequences of such an incident or accident, and
 - (iii) take the measures necessary to prevent further possible incidents or accidents;
- (b) in the event of a breach of any permit condition the operator must immediately—
- (i) inform Natural Resources Wales, and
 - (ii) take the measures necessary to ensure that compliance is restored within the shortest possible time;
- (c) in the event of a breach of permit condition which poses an immediate danger to human health or threatens to cause an immediate significant adverse effect on the environment, the operator must

immediately suspend the operation of the activities or the relevant part of it until compliance with the permit conditions has been restored.

4.3.2 Any information provided under condition 4.3.1 (a)(i), or 4.3.1 (b)(i) where the information relates to the breach of a limit specified in the permit, shall be confirmed by sending the information listed in schedule 5 to this permit within the time period specified in that schedule.

4.3.3 Where Natural Resources Wales has requested in writing that it shall be notified when the operator is to undertake monitoring and/or spot sampling, the operator shall inform Natural Resources Wales when the relevant monitoring and/or spot sampling is to take place. The operator shall provide this information to Natural Resources Wales at least 14 days before the date the monitoring is to be undertaken.

4.3.4 Natural Resources Wales shall be notified within 14 days of the occurrence of the following matters, except where such disclosure is prohibited by Stock Exchange rules:

Where the operator is a registered company:

- (a) any change in the operator's trading name, registered name or registered office address; and
- (b) any steps taken with a view to the operator going into administration, entering into a company voluntary arrangement or being wound up.

Where the operator is a corporate body other than a registered company:

- (a) any change in the operator's name or address; and
- (b) any steps taken with a view to the dissolution of the operator.

In any other case:

- (a) the death of any of the named operators (where the operator consists of more than one named individual);
- (b) any change in the operator's name(s) or address(es); and
- (c) any steps taken with a view to the operator, or any one of them, going into bankruptcy, entering into a composition or arrangement with creditors, or, in the case of them being in a partnership, dissolving the partnership.

4.3.5 Where the operator proposes to make a change in the nature or functioning, or an extension of the activities, which may have consequences for the environment and the change is not otherwise the subject of an application for approval under the Regulations or this permit:

- (a) Natural Resources Wales shall be notified at least 14 days before making the change; and
- (b) the notification shall contain a description of the proposed change in operation.

4.3.6 Natural Resources Wales shall be given at least 14 days notice before implementation of any part of the site closure plan.

4.4 Interpretation

4.4.1 In this permit the expressions listed in schedule 6 shall have the meaning given in that schedule.

4.4.2 In this permit references to reports and notifications mean written reports and notifications, except where reference is made to notification being made "without delay", in which case it may be provided by telephone.

Schedule 1 – Operation

Table S1.1 activities

Activity reference	Activity listed in Schedule 1 of the EP Regulations	Description of specified activity and WFD Annex I and II operations	Limits of specified activity and waste types
A1 Open Windrow Composting – Compost ‘Pad’	S5.4 A1(b)(i) Recovery or a mix of recovery and disposal of non-hazardous waste with a capacity exceeding 75 tonnes per day involving biological treatment.	R3: Recycling/reclamation of organic substances which are not used as solvents R13: Storage of wastes pending any of the operations numbered R1 to R12 (excluding temporary storage, pending collection, on the site where it is produced) D15: Storage pending any of the operations numbered D1 to D14 (excluding temporary storage, pending collection, on the site where it is produced)	Treatment and composting including stabilisation and sanitisation, shredding and maturation of wastes listed in table S2.2 to produce compost. The storage, physical treatment and composting of wastes under anaerobic conditions shall be prevented. Physical treatment and composting of wastes including sanitisation and stabilisation shall take place only on an impermeable surface with a sealed drainage system. Storage of green waste shall take place on hard standing with a sealed drainage system. Secure storage of wastes listed in table S2.2.
A2 Closed Vessel Composting	S5.4 A1(b) (i) Recovery or a mix of recovery and disposal of non-hazardous waste with a capacity exceeding 75 tonnes per day involving biological treatment	R3: Recycling/reclamation of organic substances which are not used as solvents R13: Storage of wastes pending any of the operations numbered R1 to R12 (excluding temporary storage, pending collection, on the site where it is produced) D15: Storage pending any of the operations numbered D1 to D14 (excluding temporary storage, pending collection, on the site where it is produced)	The storage, physical treatment and composting of wastes under anaerobic conditions shall be prevented, or where that is not practicable, minimised. The storage, physical treatment and composting of wastes shall take place on an impermeable surface with sealed drainage. Physical treatment and composting of the types of wastes listed in table S2.5. The treatment capacity of any plant shall not exceed 10 tonnes per day of animal waste. Each composting batch shall undergo an identifiable sanitisation and stabilisation stage. The sanitisation of wastes shall take place in a closed system incorporating a bio-filter. The Stabilisation phase is not restricted to the closed vessel and may take place upon an external pad as per activity A1. The bio-filter shall be specifically designed to minimise the release of odour, bioaerosols and micro-organisms and be fit for purpose. Secure storage of wastes listed in table S2.5

	Description of activities for waste operations	Limits of activities
A3 HCl Transfer & Treatment Facility	<p>R3: Recycling/reclamation of organic substances which are not used as solvents</p> <p>R4: Recycling/reclamation of metals and metal compounds</p> <p>R5: Recycling/reclamation of other inorganic materials</p> <p>R13: Storage of wastes pending the operation numbered R1 to R12 (excluding temporary storage, pending collection, on the site where it is produced</p> <p>D9: Physico-chemical treatment not specified elsewhere in Annex I which results in final compounds or mixtures which are discarded by means of any of the operations numbered D1 to D12 (e.g. evaporation, drying, calcination, etc.)</p> <p>D14: Repackaging prior to submission to any of the operations numbered D1 to D13</p> <p>D15: Storage pending any of the operations numbered D1 to D14 (excluding temporary storage, pending collection, on the site where it is produced)</p>	<p>Treatment consisting of:</p> <ul style="list-style-type: none"> • sorting • separation • shredding • compaction • dewatering <p>of waste into different components for disposal (no more than 50 tonnes per day) or recovery.</p> <p>There shall be no treatment of hazardous waste.</p> <p>Treatment and storage of wastes shall take place on an impermeable surface with sealed drainage.</p> <p>No more than a total of 50 tonnes of shredded waste vehicle tyres (waste code 19 12 04) shall be stored at site.</p> <p>The maximum quantity of hazardous waste and waste oils (in aggregate) that can be accepted and stored at the site in connection with a disposal activity shall not exceed 10 tonnes per day.</p> <p>Secure storage of wastes listed in table S2.1.</p>
A4 Soil, soil substitutes & aggregates	<p>R3: Recycling/reclamation of organic substances which are not used as solvents</p> <p>R5: Recycling/reclamation of other inorganic materials</p> <p>R13: Storage of wastes pending any of the operations numbered R1 to R12 (excluding temporary storage, pending collection, on the site where it is produced)</p>	<p>Treatment consisting of sorting, separation, screening, shredding and blending of wastes for recovery as a soil, soil substitute or aggregate of wastes listed in table S2.3</p> <p>The storage and treatment of wastes shall take place on hard standing with a sealed drainage system.</p>
A5 Street Sweepings	<p>R3: Recycling/reclamation of organic substances which are not used as solvents</p> <p>R5: Recycling/reclamation of other inorganic compounds</p> <p>R13: Storage of waste pending any of the operations numbered R1 to R12 (excluding temporary storage, pending collection, on the site where it is produced)</p> <p>D9: Physico-chemical treatment not specified elsewhere in Annex I which results in final compounds or mixtures which are discarded by means of any of the operations numbered D1 to D8 and D10 to D12.</p>	<p>Treatment consisting only of mechanical or biological processes for the disposal or recovery of this waste type.</p> <p>Physical treatment of 20 03 03 street-cleaning residues as per waste list S2.4.</p> <p>Wastes shall be stored and treated on an impermeable surface with a separate sealed drainage system.</p>

Table S1.2 Operating techniques

Description	Parts	Date Received
How to comply with your environmental permit	All	N/A
The composting industry code of practice (AfOR)	All	N/A
Industry guide for prevention and control of odours at bio waste processing facilities (AfOR)	All	N/A
BSI PAS 100 Compost Specification	All	N/A
BSI PAS 111 Recycled Wood Quality Standard	All	N/A
BS 3882:2007 Top soils Standard	All	N/A
Quality Protocol for Compost – WRAP/EA	All	N/A
Health & Safety at bio waste processing sites - AfOR	All	N/A
PPG 1: General guide to the prevention of pollution	All	N/A
PPG18: Managing fire and water and major spillages	All	N/A
Standardised protocol for the monitoring of bio aerosols at open composting facilities - AfOR	All	N/A
Environment Management System (EMS)	Appendix 7. Waste Acceptance Criteria Appendix 8. Procedures Appendix 9. Accident Management Plan	06/08/12
General Environmental Risk Assessment for the CWM Environmental Ltd CA Site and Composting Facility – Sections:	2.1 Adapted Generic risk assessment Waste Operation: Non-hazardous and Hazardous Household Waste Amenity Site.	06/08/12
	2.2 Adapted Generic risk assessment Waste Operation: Composting in Closed Systems (in-vessel composting) vessels (including animal by-products)	06/08/12
	2.3 Adapted Generic risk assessment Waste Operation: External Windrow Composting	06/08/12
Odour and Emissions Management Plan	All	06/08/12
Site Specific Bioaerosol Risk Assessment	All	06/08/12

Table S1.3 Improvement programme requirements

Reference	Requirement	Date
1	Make updates to the Environment Management System (EMS) to accurately reflect the re-classification of the site to a hazardous and non-hazardous HCI Transfer & Treatment Facility including associated activities.	COMPLETED

Schedule 2 - Waste types, raw materials and fuels

Table S2.1 Waste types and quantities – HCI Waste Transfer Station

Maximum Quantities

The total quantity of waste accepted at the site shall not exceed 100,000 tonnes a year.

Exclusions

Wastes having any of the following characteristics shall not be accepted:

- Consisting solely or mainly of dusts, powders or loose fibres
- Malodorous wastes

Waste Code	Description
01	WASTES RESULTING FROM EXPLORATION, MINING, QUARRYING AND PHYSICAL AND CHEMICAL TREATMENT OF MINERALS
01 01	wastes from mineral excavation
01 01 01	wastes from mineral metalliferous excavation
01 01 02	wastes from mineral non-metalliferous excavation
01 04	wastes from physical and chemical processing of non-metalliferous minerals
01 04 08	waste gravel and crushed rocks other than those mentioned in 01 04 07
01 04 09	waste sand and clays
02	WASTES FROM AGRICULTURE, HORTICULTURE, AQUACULTURE, FORESTRY, HUNTING AND FISHING, FOOD PREPARATION AND PROCESSING
02 01	wastes from agriculture, horticulture, aquaculture, forestry, hunting and fishing
02 01 01	sludges from washing and cleaning
02 01 03	plant-tissue waste
02 01 07	wastes from forestry
02 02	wastes from the preparation and processing of meat, fish and other foods of animal origin
02 02 02	animal tissue waste (shells for soils only)
02 04	wastes from sugar processing
02 04 01	soil from cleaning and washing beet
02 04 02	off-specification calcium carbonate
03	WASTES FROM WOOD PROCESSING AND THE PRODUCTION OF PANELS AND FURNITURE, PULP, PAPER AND CARDBOARD
03 01	wastes from wood processing and the production of panels and furniture
03 01 01	waste bark and cork
03 01 05	sawdust, shavings, cuttings, wood, particle board and veneer other than those mentioned in 03 01 04
03 03	wastes from pulp, paper and cardboard production and processing
03 03 01	waste bark and wood

Table S2.1 Waste types and quantities – HCI Waste Transfer Station**Maximum Quantities**

The total quantity of waste accepted at the site shall not exceed 100,000 tonnes a year.

Exclusions

Wastes having any of the following characteristics shall not be accepted:

- Consisting solely or mainly of dusts, powders or loose fibres
- Malodorous wastes

Waste Code	Description
03 03 05	de-inking sludges from paper recycling
03 03 07	mechanically separated rejects from pulping of waste paper and cardboard
03 03 08	wastes from sorting of paper and cardboard destined for recycling
03 03 09	lime mud waste
03 03 10	fibre rejects, fibre-, filter- and coating sludges from mechanical separation
03 03 11	sludges from on-site effluent treatment other than those mentioned in 03 03 10
04	WASTES FROM THE LEATHER, FUR AND TEXTILE INDUSTRIES
04 02	wastes from the textile industry
04 02 10	organic matter from natural products (for example grease, wax)
06	WASTES FROM INORGANIC CHEMICAL PROCESSES
06 09	Wastes from the MFSU of phosphorous chemicals and phosphorous chemical processes
06 09 02	phosphorous slag
06 09 04	calcium-based reaction wastes other than those mentioned in 06 09 03
10	WASTES FROM THERMAL PROCESSES
10 01	waste from power stations and other combustion plants
10 01 01	bottom ash and slag only
10 01 02	coal fly ash only
10 01 05	calcium-based reaction wastes from flue-gas desulphurisation in solid form
10 01 07	calcium-based reaction wastes from flue-gas desulphurisation in sludge form
10 01 15	bottom ash, slag and boiler dust from co-incineration other than those mentioned in 10 01 14
10 11	wastes from manufacture of glass and glass products
10 11 12	clean glass other than those mentioned in 10 11 11
10 12	wastes from manufacture of ceramic goods, brick, stiles and construction products
10 12 08	waste ceramics, bricks, tiles and construction products (after thermal processing)
10 13	wastes from manufacture of cement, lime and plaster products and articles and products made from them
10 13 14	waste concrete only

Table S2.1 Waste types and quantities – HCI Waste Transfer Station**Maximum Quantities**

The total quantity of waste accepted at the site shall not exceed 100,000 tonnes a year.

Exclusions

Wastes having any of the following characteristics shall not be accepted:

- Consisting solely or mainly of dusts, powders or loose fibres
- Malodorous wastes

Waste Code	Description
13	OIL WASTES AND WASTES OF LIQUID FUELS (except edible oils and those in chapters 05, 12 and 19)
13 02	waste engine, gear and lubricating oils
13 02 05*	mineral based non-chlorinated engine, gear and lubricating oils
13 02 06*	synthetic engine, gear and lubricating oils
13 02 07*	readily biodegradable engine, gear and lubricating oils
13 02 08*	other engine, gear and lubricating oils (from householders only)
15	WASTE PACKAGING; ABSORBENTS, WIPING CLOTHS, FILTER MATERIALS AND PROTECTIVE CLOTHING NOT OTHERWISE SPECIFIED
15 01	packaging (including separately collected municipal packaging waste)
15 01 01	paper and cardboard packaging
15 01 02	plastic packaging
15 01 03	wooden packaging
15 01 04	metallic packaging
15 01 05	composite packaging (only biodegradable organic packaging)
15 01 06	mixed packaging
15 01 07	glass packaging
15 01 08*	packaging containing residues of or contaminated by dangerous substances
15 01 09	textile packaging
15 01 11*	metallic packaging containing a dangerous solid porous matrix (for example asbestos), including empty pressure containers
15 02	absorbents, filter materials, wiping cloths and protective clothing
15 02 02*	absorbents, filter materials (including oil filters not otherwise specified), wiping cloths, protective clothing contaminated by dangerous substances
15 02 03	absorbents, filter materials, wiping cloths and protective clothing other than those mentioned in 15 02 02
16	WASTES NOT OTHERWISE SPECIFIED IN THE LIST
16 02	wastes from electrical and electronic equipment
16 02 12*	discarded equipment containing free asbestos
16 02 14	discarded equipment other than those mentioned in 16 02 09 to 16 02 13
16 05	gases in pressure containers and discarded chemicals
16 05 04*	gases in pressure containers (including halons) containing dangerous substances
16 05 05	gases in pressure containers other than those mentioned in 16 05 04
16 06	batteries and accumulators
16 06 01*	lead batteries
16 06 02*	ni-Cd batteries

Table S2.1 Waste types and quantities – HCI Waste Transfer Station**Maximum Quantities**

The total quantity of waste accepted at the site shall not exceed 100,000 tonnes a year.

Exclusions

Wastes having any of the following characteristics shall not be accepted:

- Consisting solely or mainly of dusts, powders or loose fibres
- Malodorous wastes

Waste Code	Description
16 06 03*	mercury-containing batteries
16 06 04	alkaline batteries (except 16 06 03)
17	CONSTRUCTION AND DEMOLITION WASTES (INCLUDING EXCAVATED SOIL FROM CONTAMINATED SITES)
17 01	concrete, bricks, tiles and ceramics
17 01 01	concrete
17 01 02	bricks
17 01 03	tiles and ceramics
17 01 07	mixtures of concrete, bricks, tiles and ceramics other than those mentioned in 17 01 06
17 02	Wood, glass and plastic
17 02 01	wood
17 02 02	glass
17 02 03	plastic
17 03	bituminous mixtures, coal tar and tarred products
17 03 01*	bituminous mixtures containing coal tar
17 03 02	bituminous mixtures other than those mentioned in 17 03 01
17 03 03*	coal tar and tarred products
17 04	metals (including their alloys)
17 04 01	copper, bronze, brass
17 04 02	aluminium
17 04 05	iron and steel
17 04 07	mixed metals
17 05	soil (including excavated soil from contaminated sites), stones and dredging spoil
17 05 04	soil and stones other than those mentioned in 17 05 03
17 05 06	dredging spoil other than those mentioned in 17 05 05
17 05 08	track ballast other than those mentioned in 17 05 07

Table S2.1 Waste types and quantities – HCI Waste Transfer Station**Maximum Quantities**

The total quantity of waste accepted at the site shall not exceed 100,000 tonnes a year.

Exclusions

Wastes having any of the following characteristics shall not be accepted:

- Consisting solely or mainly of dusts, powders or loose fibres
- Malodorous wastes

Waste Code	Description
17 06	insulation materials and asbestos-containing construction materials
17 06 01*	insulation materials containing asbestos
17 06 04	insulation materials other than those mentioned in 17 06 01 and 17 06 03
17 06 05*	construction materials containing asbestos
17 08	gypsum-based construction material
17 08 02	gypsum-based construction materials other than those mentioned in 17 08 01
17 09	other construction and demolition wastes
17 09 03*	other construction and demolition wastes (including mixed wastes) containing dangerous substances
17 09 04	mixed construction and demolition wastes other than those mentioned in 17 09 01, 17 09 02 and 17 09 03
19	WASTES FROM WASTE MANAGEMENT FACILITIES, OFF-SITE WASTE WATER TREATMENT PLANTS AND PREPARATION OF WATER INTENDED FOR HUMAN CONSUMPTION/INDUSTRIAL USE
19 05	wastes from the aerobic treatment of solid wastes
19 05 01	non-composted fraction of municipal and similar wastes
19 05 02	non-composted fraction of animal and vegetable wastes
19 05 03	off-specification compost
19 06	wastes from anaerobic treatment of waste
19 06 03	liquor from anaerobic treatment of municipal waste
19 06 04	digestate from anaerobic treatment of municipal waste
19 06 05	liquor from anaerobic treatment of animal and vegetable waste
19 06 06	digestate from anaerobic treatment of animal and vegetable waste
19 08	wastes from waste water treatment plants not otherwise specified
19 08 02	washed sewage grit (waste from desanding) free from sewage contamination only
19 08 05	sludges from treatment of urban waste water
19 08 12	sludges from biological treatment of industrial waste water other than those mentioned in 19 08 11
19 08 14	sludges from other treatment of industrial waste water other than those mentioned in 19 08 13
19 08 99	wastes not otherwise specified (stone filter media)
19 09	wastes from the preparation of water intended for human consumption or water for industrial use
19 09 01	solid waste from primary filtration and screenings
19 09 02	sludges from water clarification
19 09 03	sludges from decarbonation

Table S2.1 Waste types and quantities – HCI Waste Transfer Station**Maximum Quantities**

The total quantity of waste accepted at the site shall not exceed 100,000 tonnes a year.

Exclusions

Wastes having any of the following characteristics shall not be accepted:

- Consisting solely or mainly of dusts, powders or loose fibres
- Malodorous wastes

Waste Code	Description
19 12	wastes from the mechanical treatment of waste (for example sorting, crushing, compacting, pelletising) not otherwise specified
19 12 01	paper and cardboard
19 12 05	clean glass only
19 12 07	wood other than that mentioned in 19 12 06
19 12 09	minerals (for example sand, stones)
19 12 12	other wastes (including mixtures of materials) from mechanical treatment of wastes other than those mentioned in 19 12 11
19 13	wastes from soil and groundwater remediation
19 13 02	solid wastes from soil remediation other than those mentioned in 19 13 01
19 13 04	sludges from soil remediation other than those mentioned in 19 13 03
20	MUNICIPAL WASTES (HOUSEHOLD WASTE AND SIMILAR COMMERCIAL, INDUSTRIAL AND INSTITUTIONAL WASTES) INCLUDING SEPARATELY COLLECTED FRACTIONS
20 01	separately collected fractions (except 15 01)
20 01 01	paper and cardboard
20 01 02	glass
20 01 08	biodegradable kitchen and canteen waste
20 01 10	clothes
20 01 11	textiles
20 01 13*	solvents
20 01 14*	acids
20 01 15*	alkalines
20 01 17*	photochemicals
20 01 19*	pesticides
20 01 21*	fluorescent tubes and other mercury-containing waste
20 01 23*	discarded equipment containing chlorofluorocarbons
20 01 25	edible oil and fat
20 01 26*	oil and fat other than those mentioned in 20 01 25
20 01 27*	paint, inks, adhesives and resins containing dangerous substances
20 01 28	paint, inks, adhesives and resins other than those mentioned in 20 01 27

Table S2.1 Waste types and quantities – HCI Waste Transfer Station**Maximum Quantities**

The total quantity of waste accepted at the site shall not exceed 100,000 tonnes a year.

Exclusions

Wastes having any of the following characteristics shall not be accepted:

- Consisting solely or mainly of dusts, powders or loose fibres
- Malodorous wastes

Waste Code	Description
20 01 29*	detergents containing dangerous substances
20 01 30	detergents other than those mentioned in 20 01 29
20 01 33*	batteries and accumulators included in 16 06 01, 16 06 02 or 16 06 03 and unsorted batteries and accumulators containing these batteries
20 01 34	batteries and accumulators other than those mentioned in 20 01 33
20 01 35*	discarded electrical and electronic equipment other than those mentioned in 20 01 21 and 20 01 23 containing hazardous components
20 01 36	discarded electrical and electronic equipment other than those mentioned in 20 01 21 and 20 01 23 containing hazardous components
20 01 37*	wood containing dangerous substances
20 01 38	wood other than that mentioned in 20 01 37 (where no non-biodegradable coating or preserving substance present)
20 01 39	plastics (only if independently certified to European standard EN 14995)
20 01 40	metals
20 01 41	wastes from chimney sweeping
20 02	garden and park wastes (including cemetery waste)
20 02 01	biodegradable waste
20 02 02	soil and stones
20 02 03	other non-biodegradable wastes
20 03	other municipal wastes
20 03 01	mixed municipal waste
20 03 02	waste from markets
20 03 03	street-cleaning residues
20 03 07	bulky waste

Table S2.2 Waste types and quantities – Open windrow composting ‘PAD’**Maximum Quantities**

The total quantity of waste accepted at the site shall not exceed 100,000 tonnes a year.

Exclusions

Wastes having any of the following characteristics shall not be accepted:

- Consisting solely or mainly of dusts, powders or loose fibres
- Hazardous wastes

Waste Code	Description
02	WASTES FROM AGRICULTURE, HORTICULTURE, AQUACULTURE, FORESTRY, HUNTING AND FISHING, FOOD PREPARATION AND PROCESSING
02 01	wastes from agriculture, horticulture, aquaculture, forestry, hunting and fishing
02 01 03	plant-tissue waste
02 01 04	waste plastics (BIODEGRADABLE packaging only)
02 01 06	animal faeces, urine and manure (including spoiled straw), effluent, collected separately and treated off-site
02 01 07	wastes from forestry – only if plant material
02 01 99	wastes not otherwise specified (mushroom compost only)
02 02	wastes from the preparation and processing of meat, fish and other foods of animal origin
02 02 99	horse manure, farmyard manure and bedding
02 03	wastes from fruit, vegetables, cereals, edible oils, cocoa, coffee, tea and tobacco preparation and processing; conserve production; yeast and yeast extract production, molasses preparation and fermentation
02 03 04	biodegradable materials unsuitable for consumption or processing (biodegradable only)
02 04	Wastes from sugar processing
02 04 01	soil from cleaning and washing beet
02 04 02	off-specification calcium carbonate (for blending at the end of the composting process only)
02 06	wastes from the baking and confectionery industry
02 06 01	materials unsuitable for consumption or processing
02 07	wastes from the production of alcoholic and non-alcoholic beverages (except coffee, tea and cocoa)
02 07 01	wastes from washing, cleaning and mechanical reduction of raw materials
02 07 02	wastes from spirits distillation
02 07 04	materials unsuitable for consumption or processing
02 07 99	wastes not otherwise specified (malt husks, malt sprouts, yeast and yeast-like residues only)
03	WASTES FROM WOOD PROCESSING AND THE PRODUCTION OF PANELS AND FURNITURE, PULP, PAPER AND CARDBOARD
03 01	wastes from wood processing and the production of panels and furniture
03 01 01	waste bark and cork
03 01 05	sawdust, shavings, wood, particle board and veneer other than those containing dangerous substances other than 03 01 04.
03 03	wastes from pulp, paper and cardboard production and processing
03 03 01	waste bark and wood
03 03 05	de-inking sludge from paper recycling

Table S2.2 Waste types and quantities – Open windrow composting ‘PAD’**Maximum Quantities**

The total quantity of waste accepted at the site shall not exceed 100,000 tonnes a year.

Exclusions

Wastes having any of the following characteristics shall not be accepted:

- Consisting solely or mainly of dusts, powders or loose fibres
- Hazardous wastes

Waste Code	Description
03 03 07	mechanically separated rejects from pulping of waste paper and cardboard
03 03 09	lime mud waste (for blending at the end of the composting process only)
03 03 10	fibre rejects only (not containing hazardous substances)
04	WASTES FROM THE LEATHER, FUR AND TEXTILE INDUSTRIES
04 02	wastes from the leather and fur industry
04 02 10	organic matter from natural products (un-dyed and untreated, for example grease, wax)
15	WASTE PACKAGING; ABSORBENTS, WIPING CLOTHS, FILTER MATERIALS AND PROTECTIVE CLOTHING NOT OTHERWISE SPECIFIED
15 01	packaging (including separately collected municipal packaging waste)
15 01 01	paper and cardboard packaging (not containing non-biodegradable veneers or plastics)
15 01 03	wooden packaging (untreated)
15 01 05	composite packaging (only biodegradable organic packaging)
15 01 09	textile packaging (only entirely natural fibres)
17	CONSTRUCTION AND DEMOLITION WASTES (INCLUDING EXCAVATED SOIL FROM CONTAMINATED SITES)
17 02	wood, glass and plastic
17 02 01	wood (only entirely natural fibres)
17 05	soil (including excavated soil from contaminated sites), stones and dredging spoil
17 05 06	dewatered dredging spoil and plant tissue waste from inland waters, not containing Japanese Knotweed and not containing dangerous substances'
19	WASTES FROM WASTE MANAGEMENT FACILITIES, OFF-SITE WASTE WATER TREATMENT PLANTS AND THE PREPARATION OF WATER INTENDED FOR HUMAN CONSUMPTION AND WATER FOR INDUSTRIAL USE
19 05	wastes from aerobic treatment of solid wastes
19 05 03	off-specification compost
19 06	wastes from anaerobic treatment of wastes
19 06 04	digestate from anaerobic treatment of municipal wastes
19 08	Wastes from waste water treatment plants not otherwise specified
19 08 05	sludges from treatment of urban waste water
19 08 12	sludges from biological treatment of industrial waste water other than those mentioned in 19 08 11
19 08 14	sludges from other treatment of industrial waste water other than those mentioned in 19 08 13
19 09	wastes from the preparation of water intended for human consumption or water for industrial use
19 09 01	solid waste from primary filtration and screenings
19 09 02	sludges from water clarification (organic waste only)

Table S2.2 Waste types and quantities – Open windrow composting ‘PAD’**Maximum Quantities**

The total quantity of waste accepted at the site shall not exceed 100,000 tonnes a year.

Exclusions

Wastes having any of the following characteristics shall not be accepted:

- Consisting solely or mainly of dusts, powders or loose fibres
- Hazardous wastes

Waste Code	Description
19 09 03	sludges from decarbonation (organic waste only)
19 12	wastes from the mechanical treatment of waste (for example sorting, crushing, compacting, pelletising) not otherwise specified
19 12 01	paper and cardboard not containing non-biodegradable veneers or plastics
19 12 07	wood other than that mentioned in 19 12 06
19 12 12	other wastes (including mixtures of materials) from mechanical treatment of wastes other than those mentioned in 19 12 11
20	MUNICIPAL WASTES (HOUSEHOLD WASTE AND SIMILAR COMMERCIAL, INDUSTRIAL AND INSTITUTIONAL WASTES) INCLUDING SEPARATELY COLLECTED FRACTIONS
20 01	Separately collected fractions (except 15 01)
20 01 01	paper and cardboard
20 01 38	wood other than that mentioned in 20 01 37
20 02	garden and park wastes (including cemetery waste)
20 02 01	biodegradable waste (comprising wood and plant tissue only)
20 02 02	soil and stones (for blending at the end of the composting process)
20 03	other municipal wastes
20 03 02	waste from markets (biodegradable only)

Table S2.3 Permitted waste types and quantities for the production of soil, soil substitutes and aggregates

Exclusions

Wastes having any of the following characteristics shall not be accepted:

- Consisting solely or mainly of dusts, powders or loose fibres
- Hazardous wastes

Waste code	Description
01	WASTES RESULTING FROM EXPLORATION, MINING, QUARRYING AND PHYSICAL AND CHEMICAL TREATMENT OF MINERALS
01 04	wastes from physical and chemical processing of non-metalliferous minerals
01 04 08	waste gravel and crushed rocks other than those mentioned in 01 04 07
01 04 09	waste sand and clays
02	WASTES FROM AGRICULTURE, HORTICULTURE, AQUACULTURE, FORESTRY, HUNTING AND FISHING, FOOD PREPARATION AND PROCESSING
02 02	wastes from the preparation and processing of meat, fish and other foods of animal origin
02 02 02	animal tissue waste (shells for soils only)
03	WASTES FROM WOOD PROCESSING AND THE PRODUCTION OF PANELS AND FURNITURE, PULP, PAPER AND CARDBOARD
03 01	wastes from wood processing and the production of panels and furniture
03 01 01	waste bark and cork
03 03	wastes from pulp, paper and cardboard production and processing
03 03 01	waste bark and wood
10	WASTES FROM THERMAL PROCESSES
10 01	waste from power stations and other combustion plants
10 01 01	bottom ash and slag only
10 01 02	coal fly ash only
10 01 05	calcium-based reaction wastes from flue-gas desulphurisation in solid form
10 01 07	calcium-based reaction wastes from flue-gas desulphurisation in sludge form
10 01 15	bottom ash, slag and boiler dust from co-incineration other than those mentioned in 10 01 14
10 11	wastes from manufacture of glass and glass products
10 11 12	clean glass other than those mentioned in 10 11 11
10 12	wastes from manufacture of ceramic goods, brick, stiles and construction products
10 12 08	waste ceramics, bricks, tiles and construction products(after thermal processing)
10 13	wastes from manufacture of cement, lime and plaster products and articles and products made from them
10 13 14	waste concrete only
15	WASTE PACKAGING; ABSORBENTS, WIPING CLOTHS, FILTER MATERIALS AND PROTECTIVE CLOTHING NOT OTHERWISE SPECIFIED
15 01	packaging (including separately collected municipal packaging waste)
15 01 07	glass packaging
17	CONSTRUCTION AND DEMOLITION WASTES (INCLUDING EXCAVATED SOIL FROM CONTAMINATED SITES)
17 01	concrete, bricks, tiles and ceramics
17 01 01	concrete
17 01 02	bricks
17 01 03	tiles and ceramics
17 01 07	mixtures of concrete, bricks, tiles and ceramics other than those mentioned in 17 01 06
17 02	wood, glass and plastic
17 02 02	glass
17 03	bituminous mixtures, coal tar and tarred products

Table S2.3 Permitted waste types and quantities for the production of soil, soil substitutes and aggregates

Exclusions

Wastes having any of the following characteristics shall not be accepted:

- Consisting solely or mainly of dusts, powders or loose fibres
- Hazardous wastes

Waste code	Description
17 03 02	bituminous mixtures other than those mentioned in 17 03 01
17 05	soil (including excavated soil from contaminated sites), stones and dredging spoil
17 05 04	soil and stones other than those mentioned in 17 05 03
17 05 06	dredging spoil other than those mentioned in 17 05 05
17 05 08	track ballast other than those mentioned in 17 05 07
17 06	insulation materials and asbestos-containing construction materials
17 06 04	insulation materials other than those mentioned in 17 06 01 and 17 06 03
17 08	gypsum-based construction material
17 08 02	gypsum-based construction materials other than those mentioned in 17 08 01
19	WASTES FROM WASTE MANAGEMENT FACILITIES, OFF-SITE WASTE WATER TREATMENT PLANTS AND PREPARATION OF WATER INTENDED FOR HUMAN CONSUMPTION/INDUSTRIAL USE
19 05	wastes from the aerobic treatment of solid wastes
19 05 03	off-specification compost
19 08	wastes from waste water treatment plants not otherwise specified
19 08 02	washed sewage grit (waste from desanding) free from sewage contamination only
19 08 99	wastes not otherwise specified (stone filter media)
19 09	wastes from the preparation of water intended for human consumption or water for industrial use
19 09 02	sludges from water clarification
19 12	wastes from the mechanical treatment of waste (for example sorting, crushing, compacting, pelletising) not otherwise specified
19 12 05	clean glass only
19 12 09	minerals (for example sand, stones)
19 12 12	other wastes (including mixtures of materials) from mechanical treatment of wastes other than those mentioned in 19 12 11
19 13	wastes from soil and groundwater remediation
19 13 02	solid wastes from soil remediation other than those mentioned in 19 13 01
19 13 04	sludges from soil remediation other than those mentioned in 19 13 03
20	MUNICIPAL WASTES (HOUSEHOLD WASTE AND SIMILAR COMMERCIAL, INDUSTRIAL AND INSTITUTIONAL WASTES) INCLUDING SEPARATELY COLLECTED FRACTIONS
20 01	separately collected fractions (except 15 01)
20 01 02	glass
20 02	garden and park wastes (including cemetery waste)
20 02 02	soil and stones

Table S2.4 Permitted waste types and quantities for the production of soil, soil substitutes and aggregates (Processing street-cleaning residues)

Exclusions

Wastes having any of the following characteristics shall not be accepted:

- Consisting solely or mainly of dusts, powders or loose fibres
- Hazardous wastes

Waste code	Description
20	MUNICIPAL WASTES (HOUSEHOLD WASTE AND SIMILAR COMMERCIAL, INDUSTRIAL AND INSTITUTIONAL WASTES) INCLUDING SEPARATELY COLLECTED FRACTIONS
20 03	other municipal wastes
20 03 03	street-cleaning residues

Table S2.5 Waste types and quantities for closed vessel composting

Maximum Quantities

The total quantity of waste accepted at the site shall be less than 100,000 tonnes a year.

Exclusions

Wastes having any of the following characteristics shall not be accepted:

- Consisting solely or mainly of dusts, powders or loose fibres
- Hazardous wastes

Waste Code	Description
02	WASTES FROM AGRICULTURE, HORTICULTURE, AQUACULTURE, FORESTRY, HUNTING AND FISHING, FOOD PREPARATION AND PROCESSING
02 01	wastes from agriculture, horticulture, aquaculture, forestry, hunting and fishing
02 01 01	sludges from washing and cleaning (food preparation and processing waste, food washing only)
02 01 02	animal tissue waste
02 01 03	plant-tissue waste
02 01 06	animal faeces, urine and manure (including spoiled straw)
02 01 07	wastes from forestry (comprising wood and plant tissue)
02 01 99	wastes not otherwise specified (mushroom compost only)
02 02	wastes from the preparation and processing of meat, fish and other foods of animal origin
02 02 01	sludges from washing and cleaning (process water and food washing waste only)
02 02 02	animal tissue waste
02 02 03	materials unsuitable for consumption or processing
02 02 99	wastes not otherwise specified (horse manure, farmyard manure and bedding only)
02 03	wastes from fruit, vegetables, cereals, edible oils, cocoa, coffee, tea and tobacco preparation and processing; conserve production; yeast and yeast extract production, molasses preparation and fermentation
02 03 01	sludges from washing, cleaning, peeling, centrifuging and separation
02 03 04	biodegradable materials unsuitable for consumption or processing (other than those containing dangerous substances)
02 03 05	sludges from on-site effluent treatment
02 05	wastes from the dairy products industry
02 05 01	biodegradable materials unsuitable for consumption or processing (other than those containing dangerous substances)

Table S2.5 Waste types and quantities for closed vessel composting**Maximum Quantities**

The total quantity of waste accepted at the site shall be less than 100,000 tonnes a year.

Exclusions

Wastes having any of the following characteristics shall not be accepted:

- Consisting solely or mainly of dusts, powders or loose fibres
- Hazardous wastes

Waste Code	Description
02 06	wastes from the baking and confectionery industry
02 06 01	biodegradable materials unsuitable for consumption or processing (other than those containing dangerous substances)
02 07	wastes from the production of alcoholic and non-alcoholic beverages (except coffee, tea and cocoa)
02 07 01	spent grains or hops.
02 07 02	whisky filter sheets or cloths.
02 07 04	material unsuitable for consumption or processing
02 07 99	Wastes not otherwise specified (malt husks, malt sprouts, spent grains, sludges from the production process, yeast and yeast-like residues only)
03	WASTES FROM WOOD PROCESSING AND THE PRODUCTION OF PANELS AND FURNITURE, PULP, PAPER AND CARDBOARD
03 01	wastes from wood processing and the production of panels and furniture
03 01 01	waste bark and cork
03 01 05	Sawdust, shavings, wood, particle board and veneer other than those containing dangerous substances other than 03 01 04. Untreated wood only. NO VENEERS OR PRESERVATIVES
03 03	wastes from pulp, paper and cardboard production and processing
03 03 01	waste bark and wood
03 03 10	fibre rejects (not containing hazardous substances)
04	WASTES FROM THE LEATHER FUR AND TEXTILE INDUSTRIES
04 02	Waste from the textile industry
04 02 10	organic matter from natural products (from example grease, wax)
15	WASTE PACKAGING; ABSORBENTS, WIPING CLOTHS, FILTER MATERIALS AND PROTECTIVE CLOTHING NOT OTHERWISE SPECIFIED
15 01	packaging (including separately collected municipal packaging waste)
15 01 01	paper and cardboard packaging not containing veneers or plastic coated.
15 01 03	wooden packaging (untreated)
15 01 05	composite packaging (only biodegradable organic packaging)
15 01 09	textile packaging (only entirely natural fibres)
17	CONSTRUCTION AND DEMOLITION WASTES (INCLUDING EXCAVATED SOIL FROM CONTAMINATED SITES)
17 02	wood, glass and plastic
17 02 01	wood (untreated)

Table S2.5 Waste types and quantities for closed vessel composting**Maximum Quantities**

The total quantity of waste accepted at the site shall be less than 100,000 tonnes a year.

Exclusions

Wastes having any of the following characteristics shall not be accepted:

- Consisting solely or mainly of dusts, powders or loose fibres
- Hazardous wastes

Waste Code	Description
19	WASTES FROM WASTE MANAGEMENT FACILITIES, OFF-SITE WASTE WATER TREATMENT PLANTS AND PREPARATION OF WATER INTENDED FOR HUMAN CONSUMPTION/INDUSTRIAL USE
19 05	wastes from the aerobic treatment of solid wastes
19 05 03	off-specification compost (only if the compost is derived from input types allowed by the QP requirements)
19 06	waste from the anaerobic treatment of waste
19 06 03	liquor from anaerobic treatment of municipal waste
19 06 04	digestate from anaerobic treatment of municipal waste
19 06 05	liquor from anaerobic treatment of animal and vegetable waste
19 06 06	digestate from anaerobic treatment of animal and vegetable waste
19 12	wastes from the mechanical treatment of waste (for example sorting, crushing, compacting, pelletising) not otherwise specified
19 12 01	paper and cardboard
19 12 07	wood other than that mentioned in 19 12 06
19 12 12	other wastes (including mixtures of materials) from mechanical treatment of wastes other than those mentioned in 19 12 11
20	MUNICIPAL WASTES (HOUSEHOLD WASTE AND SIMILAR COMMERCIAL, INDUSTRIAL AND INSTITUTIONAL WASTES) INCLUDING SEPARATELY COLLECTED FRACTIONS
20 01	separately collected fractions (except 15 01)
20 01 01	paper and cardboard
20 01 08	biodegradable kitchen and canteen waste
20 01 25	edible oil and fat
20 01 38	wood other than that mentioned in 20 01 37 (where no non-biodegradable coating or preserving substance present)
20 02	garden and park wastes (including cemetery waste)
20 02 01	biodegradable waste (comprising wood and plant tissue)
20 03	other municipal wastes
20 03 01	mixed municipal waste (must be separately collected biodegradable wastes allowed under the Quality Protocol for compost only)
20 03 02	biodegradable waste from markets

Schedule 3 – Emissions and monitoring

Table S3.1 Point Source emissions to water (other than sewer) and land – emission limits and monitoring requirements

Emission point ref. & location	Parameter	Source	Limit (incl. unit)	Reference Period	Monitoring frequency	Monitoring standard or method
Rainwater effluent lagoon located on the external pad area	No parameters set	Surface water from external pad area	None specified	Every inspection	Daily	Visual inspection
Interceptor East	No parameters set	Surface water from external yard	None specified	Every inspection	As required	Visual inspection
Interceptor West	No parameters set	Surface water from CA site yard	None specified	Every inspection	As required	Visual inspection

Table S3.2 Point source emissions to sewer, effluent treatment plant or other transfers off-site– emission limits and monitoring requirements

Emission point ref. & location	Parameter	Source	Limit (incl. Unit)	Reference period	Monitoring frequency	Monitoring standard or method
IVC Effluent tanks	No parameters set	Site effluent holding tanks and bunded area	None specified	Every inspection	As required	Visual inspection
HCI WTS bunded waste oil tank area	No parameters set	Holding tank & overspill	None specified	Every inspection	As required	Visual inspection

Table S 3.3 Process monitoring requirements

Monitoring point	Substance or parameter	Monitoring frequency	Monitoring method	Other specifications
Internal for each enclosed composting vessel	Temperature	Continuous	Thermocouple probe	None
	Moisture	As required	Moisture meter or touch test	None
Internal for each windrow and for any sample of waste or compost	Temperature	As required	Thermocouple probe	Monitoring shall be carried out to ensure aerobic conditions are maintained and to prevent waste becoming anaerobic
	Moisture	As required	Moisture meter or moisture touch test	
Biofilter	Temperature, moisture, thatching and compaction	As required	Thermocouple probe and moisture meter or touch test	Biofilters should be regularly checked and maintained to ensure appropriate temperature and moisture content.

Table S3.4 Bioaerosol monitoring requirements

Location or description of point of measurement	Parameter	Bioaerosol threshold limits (CFU m ⁻³)	Monitoring frequency	Monitoring standard or method	Other specifications
Bioaerosols shall be monitored at a minimum of three separate locations, as described in the Industry Standard Protocol	Gram-negative bacteria	300	Quarterly	In accordance with the Industry Standard Protocol, and, for gram-negative bacteria, together with the Environment Agency's "Guidance on the evaluation of bioaerosol risk assessments for composting facilities"	As described in the Industry Standard Protocol, including all the additional data requirements specified therein
	Total bacteria	1000			
	Aspergillus Fumigatus	500			

Table S3.5 Surface water monitoring requirements

Location or description of point of measurement	Parameter	Monitoring frequency	Monitoring standard or method	Other specifications
The watercourse adjacent to the site which flows south before joining the Afon-y-Bantwen	Any visible oil and grease	Weekly or as agreed in writing with Natural Resources Wales	Visual inspections	-

Schedule 4 - Reporting

Parameters, for which reports shall be made, in accordance with conditions of this permit, are listed below.

Table S4.1 Reporting of monitoring data

Parameter	Reporting period	Period begins
Bioaerosol monitoring as required by condition 3.5.1(c)	Quarterly or as agreed in writing by the Natural Resources Wales	1 January, 1 April, 1 July, 1 October

Table S4.2 Reporting forms

Media/parameter	Reporting format
Bioaerosol monitoring	As specified in the Industry Standard Protocol or other form as agreed in writing by the Natural Resources Wales

Schedule 5 - Notification

These pages outline the information that the operator must provide.

Units of measurement used in information supplied under Part A and B requirements shall be appropriate to the circumstances of the emission. Where appropriate, a comparison should be made of actual emissions and authorised emission limits.

If any information is considered commercially confidential, it should be separated from non-confidential information, supplied on a separate sheet and accompanied by an application for commercial confidentiality under the provisions of the EP Regulations.

Part A

Permit Number	
Name of operator	
Location of Facility	
Time and date of the detection	

(a) Notification requirements for any activity that gives rise to an incident or accident which significantly affects or may significantly affect the environment	
To be notified Immediately	
Date and time of the event	
Reference or description of the location of the event	
Description of where any release into the environment took place	
Substances(s) potentially released	
Best estimate of the quantity or rate of release of substances	
Measures taken, or intended to be taken, to stop any emission	
Description of the failure or accident.	

(b) Notification requirements for the breach of a permit condition	
To be notified immediately	
Emission point reference/ source	
Parameter(s)	
Limit	
Measured value and uncertainty	
Date and time of monitoring	
Measures taken, or intended to be taken, to stop the emission	

Time periods for notification following detection of a breach of a limit	
Parameter	Notification period

(c) In the event of a breach of permit condition which poses an immediate danger to human health or threatens to cause an immediate significant adverse effect on the environment:

To be notified immediately	
Description of where the effect on the environment was detected	
Substances(s) detected	
Concentrations of substances detected	
Date of monitoring/sampling	

Part B - to be submitted as soon as practicable

Any more accurate information on the matters for notification under Part A.	
Measures taken, or intended to be taken, to prevent a recurrence of the incident	
Measures taken, or intended to be taken, to rectify, limit or prevent any pollution of the environment which has been or may be caused by the emission	
The dates of any unauthorised emissions from the facility in the preceding 24 months.	

Name*	
Post	
Signature	
Date	

* authorised to sign on behalf of the operator

Schedule 6 - Interpretation

“*accident*” means an accident that may result in pollution.

“*Annex I*” means Annex I to Directive 2008/98/EC of the European Parliament and of the Council of waste.

“*Annex II*” means Annex II to Directive 2008/98/EC of the European Parliament and of the Council of waste.

“*application*” means the application for this permit, together with any additional information supplied by the operator as part of the application and any response to a notice served under Schedule 5 to the EP Regulations.

“*authorised officer*” means any person authorised by Natural Resources Wales under section 108(1) of The Environment Act 1995 to exercise, in accordance with the terms of any such authorisation, any power specified in section 108(4) of that Act.

“*bioaerosol threshold limits*” means the maximum acceptable bioaerosol concentrations at the nearest sensitive receptor, or at an equivalent distance downwind of the composting operations, which are attributable to the composting operations. The maximum acceptable concentrations are respectively 300, 1000 and 500 CFU m⁻³ for gram-negative bacteria, total bacteria and *Aspergillus fumigatus*.

“*compost*” means solid particulate material that is the result of composting, which has been sanitised and stabilised, and which confers beneficial effects when added to soil, used as a component of growing media or used in another way in conjunction with plants.

“*composting*” means the biological decomposition of organic materials, under conditions that are predominantly aerobic and that allow the development of thermophilic temperatures as a result of biologically produced heat.

“*D*” means a disposal operation provided for in Annex I to Directive 2008/98/EC of the European Parliament and of the Council on waste.

“*disposal*” means any of the operations provided for in Annex IIA to Directive 2006/12/EC of the European Parliament and of the Council of 5 April 2006 on Waste.

“*emissions to land*” includes emissions to groundwater.

“*EP Regulations*” means The Environmental Permitting (England and Wales) Regulations SI 2010 No.675 and words and expressions used in this permit which are also used in the Regulations have the same meanings as in those Regulations.

“*emissions of substances not controlled by emission limits*” means emissions of substances to air, water or land from the activities, either from the emission points specified in schedule 3 or from other localised or diffuse sources, which are not controlled by an emission or background concentration limit.

“*groundwater*” means all water, which is below the surface of the ground in the saturation zone and in direct contact with the ground or subsoil.

“*hazardous waste*” has the meaning given in the Hazardous Waste (England and Wales) Regulations 2005 No.894, the Hazardous Waste (Wales) Regulations 2005 No. 1806 (W.138), the List of Wastes (England) Regulations 2005 No.895 and the List of Wastes (Wales) Regulations 2005 No. 1820 (W.148).

“*Industrial Emissions Directive*” means DIRECTIVE 2010/75/EU OF THE EUROPEAN PARLIAMENT AND OF THE COUNCIL of 24 November 2010 on industrial emissions.

“*Industry Standard Protocol*” means “A standardised protocol for the monitoring of bio aerosols at open composting facilities” published by the Association for Organics Recycling and developed in conjunction with the Environment Agency.

“*maturation*” means a stage when by agitating and turning the compost it no longer results in reheating and the monitored temperature falls to ambient without the compost being too dry or anaerobic. Phytotoxins that are formed during the 'active' composting phase are metabolised by micro-organisms, which will result in the final material not being harmful to plants. This usually coincides with drop in pH toward neutral, and the conversion of ammonia into nitrates and recolonisation of beneficial micro-organisms. The maturation phase may need active management by turning to prevent the material becoming anaerobic.

"*MCERTS*" means the Environment Agency's Monitoring Certification Scheme.

"*nearest sensitive receptors*" means the nearest place to the composting operations where people are likely to be for prolonged or frequent periods. This term would therefore apply to dwellings (including any associated gardens) and to workplaces where workers would frequently be present. It does not apply to the operators of composting facilities or their staff while carrying out the composting operation as their health is covered by Health and Safety legislation.

"*Pests*" means Birds, Vermin and Insects.

"*quarter*" means a calendar year quarter commencing on 1 January, 1 April, 1 July or 1 October.

"*R*" means a recovery operation provided for in Annex II to Directive 2008/98/EC of the European Parliament and of the Council on Waste.

"*recovery*" means any of the operations provided for in Annex IIB to Directive 2006/12/EC of the European Parliament and of the Council of 5 April 2006 on Waste.

"*Waste code*" means the six digit code referable to a type of waste in accordance with the List of Wastes (England) Regulations 2005, or List of Wastes (Wales) Regulations 2005, as appropriate, and in relation to hazardous waste, includes the asterisk.

"*WFD*" means Waste Framework Directive 2008/98/EC of the European Parliament and of the Council on waste.

"*Waste Framework Directive*" or "*WFD*" means Waste Framework Directive 2008/98/EC of the European Parliament and of the Council on waste.

"*year*" means calendar year ending 31 December.

Where a minimum limit is set for any emission parameter, for example pH, reference to exceeding the limit shall mean that the parameter shall not be less than that limit.

Unless otherwise stated, any references in this permit to concentrations of substances in emissions into air means:

in relation to emissions from combustion processes, the concentration in dry air at a temperature of 273K, at a pressure of 101.3 kPa and with an oxygen content of 3% dry for liquid and gaseous fuels, 6% dry for solid fuels; and/or

in relation to emissions from non-combustion sources, the concentration at a temperature of 273K and at a pressure of 101.3 kPa, with no correction for water vapour content

Schedule 7 - Site plan

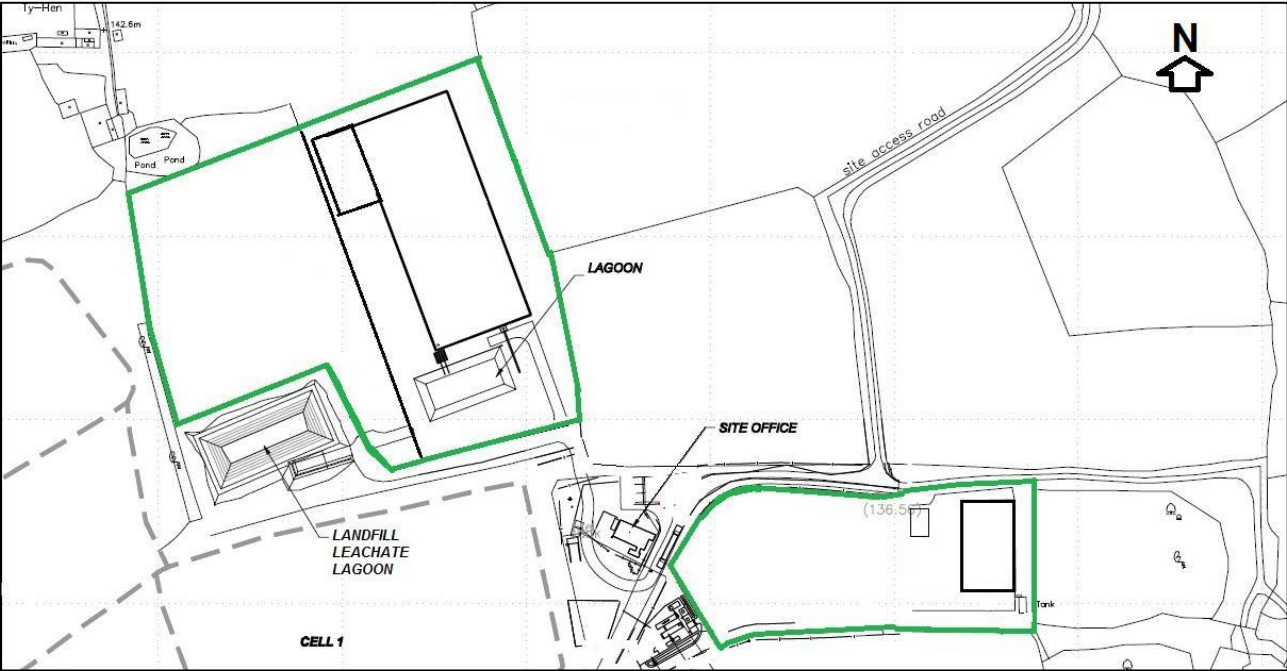

© Crown Copyright and database right [2015]. Ordnance Survey licence number 100019741.

END OF PERMIT